

- \* a PART OF ITEM 10
- \* b PART OF ITEM 28
- \* c PART OF ITEM 34
- \* d PART OF ITEM 36
- \* e PART OF ITEM 39
- \* f PART OF ITEM 13

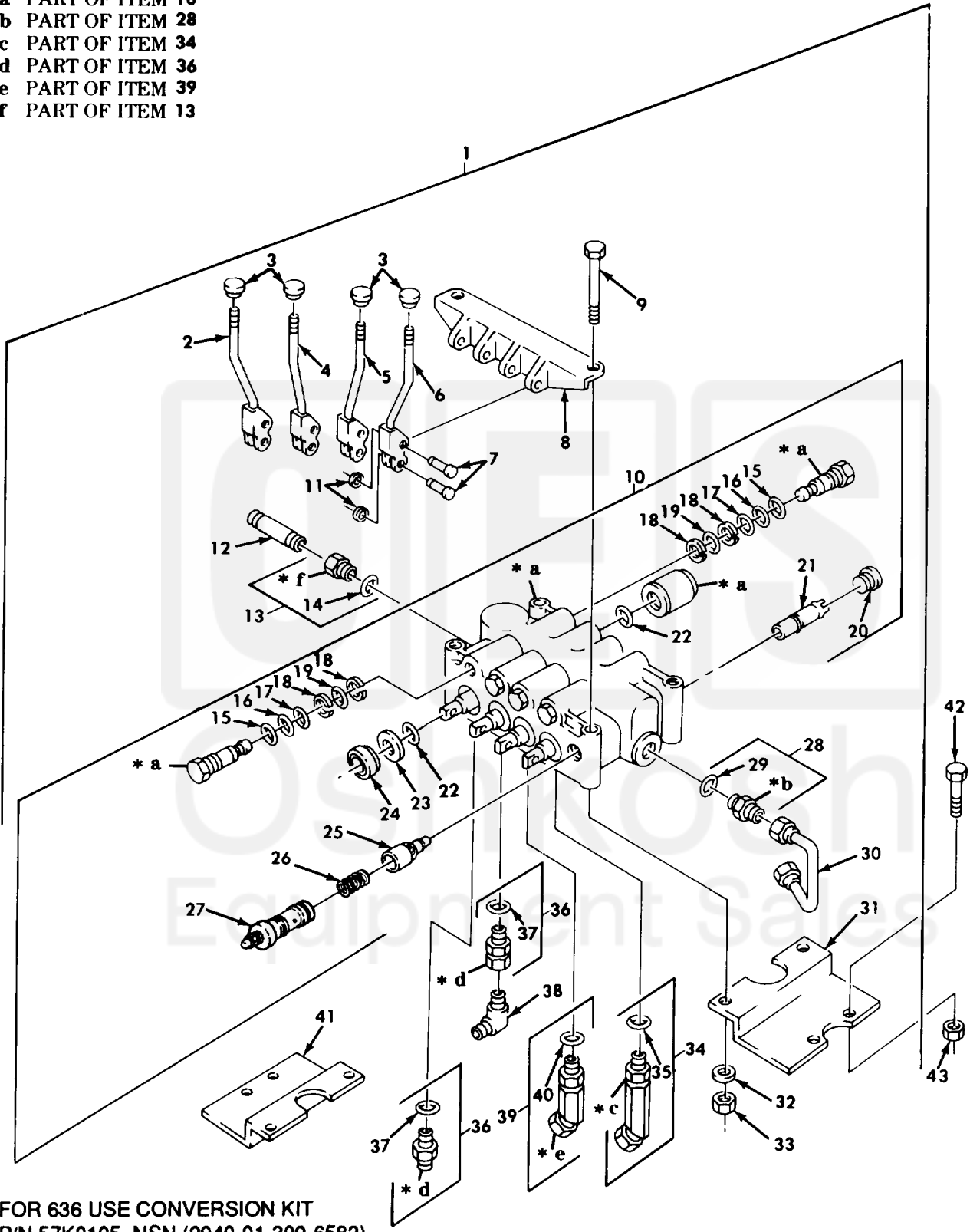

\*a FOR 636 USE CONVERSION KIT  
P/N 57K0105, NSN (2940-01-309-6582).

Figure 411. Wrecker Gondola Hoist Control Valve Assembly.

ITEM NO	SMR CODE	CAGEC	PART NUMBER	DESCRIPTION AND USABLE ON CODES(UOC)	QTY
GROUP 2001 HOIST, CRANE, OR WINCH ASSEMBLY					
FIG. 411 WRECKER GONDOLA HOIST CONTROL VALVE ASSEMBLY					
1	PAOFH	19207	11621117	VALVE, HOIST CONTROL UOC: 622	1
2	PAOZZ	19207	11621121-1	LEVER, MANUAL CONTROL UOC: 622	1
3	PAOZZ	19207	10900172	KNOB UOC: 622	4
4	PAOZZ	19207	11640398-1	LEVER, MANUAL CONTROL UOC: 622	1
5	PAOZZ	19207	11640398-2	LEVER, MANUAL CONTROL UOC: 622	1
6	PAOZZ	19207	11621121-2	LEVER, MANUAL CONTROL UOC: 622	1
7	PAOZZ	19207	11621118	PIN, GROOVED, HEADED UOC: 622	8
8	PFOZZ	19207	11621122-2	BASE, MOUNTING UOC: 622	1
9	PAOZZ	96906	MS90728-127	SCREW, CAP, HEXAGON H UOC: 622	4
10	PAOFH	19207	11621116	VALVE ASSEMBLY, CONTROL UOC: 622	1
11	PAOZZ	96906	MS90707-1050	RING, RETAINING UOC: 622	8
12	PAOZZ	96906	MS51953-154	NIPPLE, PIPE UOC: 622	1
13	PAOZZ	19207	11621891	ADAPTER, STRAIGHT, PIPE UOC: 622	1
14	PAOZZ	96906	MS28775-128	PACKING, PREFORMED UOC: 622	1
15	PAFZZ	96906	MS28775-117	PACKING, PREFORMED PART OF KIT P/N 5704273 UOC: 622	8
16	PAFZZ	96906	MS28775-115	PACKING, PREFORMED PART OF KIT P/N 5704273 UOC: 622	8
17	PAFZZ	96906	MS28774-115	RETAINER, PACKING PART OF KIT P/N 5704273 UOC: 622	8
18	PAFZZ	96906	MS28774-114	PACKING, PREFORMED PART OF KIT P/N 5704273 UOC: 622	16
19	PAFZZ	96906	MS28775-114	PACKING, PREFORMED PART OF KIT P/N 5704273 UOC: 622	8
20	PAFZZ	19207	11662758	PLUG, PIPE PART OF KIT P/N 5704274 UOC: 622	1
21	PAFZZ	19207	11662536	SEAT, RETAINER ASSEMBLY PART OF KIT	1

SECTION II (1)	SMR (2)	CAGEC (3)	PART NUMBER (4)	DESCRIPTION AND USABLE ON CODES(UOC) (5)	QTY (6)
				P/N 5704274 UOC:622	
22	PAFZZ	96906	MS28775-120	PACKING,PREFORMED UOC:622	8
23	PAFZZ	19207	11640447	RETAINER,PACKING UOC:622	1
24	PAFZZ	19207	11640446	WIPER ASSEMBLY,SPOO UOC:622	1
25	PAFZZ	19207	11662760	PLUNGER AND SCREEN PART OF KIT P/N 5704274 UOC:622	1
26	PAFZZ	09990	612668	SPRING,SPECIAL PART OF KIT P/N 5704274 UOC:622	1
27	PAFZZ	19207	11662537	VALVE,REGULATING,FL PART OF KIT P/N 5704274	1
28	PAOZZ	19207	11621892	ADAPTER,STRAIGHT,TU UOC:622	1
29	PAOZZ	96906	MS28778-20	PACKING,PREFORMED UOC:622	1
30	PAOZZ	19207	11621120	TUBE ASSEMBLY,METAL UOC:622	1
31	PFOZZ	19207	11621124	BRACKET,DOUBLE ANGL UOC:622	1
32	PAOZZ	96906	MS35338-48	WASHER,LOCK UOC:622	4
33	PAOZZ	96906	MS51967-14	NUT,PLAIN,HEXAGON UOC:622	4
34	PAOZZ	19207	11621894-2	ELBOW,PIPE TO BOSS UOC:622	2
35	PAOZZ	96906	MS28778-16	PACKING,PREFORMED UOC:622	1
36	PAOZZ	19207	11621890	ADAPTER,STRAIGHT,TU UOC:622	3
37	PAOZZ	96906	MS28778-16	PACKING,PREFORMED UOC:622	1
38	PAOZZ	24617	9410285	ELBOW,TUBE UOC:622	2
39	PAOZZ	19207	11621894-1	ELBOW,PIPE TO BOSS UOC:622	2
40	PAOZZ	96906	MS28778-16	PACKING,PREFORMED UOC:622	1
41	PFOZZ	19207	11621123	BRACKET,DOUBLE ANGL UOC:622	1
42	PAOZZ	96906	MS90727-111	SCREW,CAP,HEXAGON H UOC:622	4
43	PAOZZ	96906	MS51943-40	NUT,SELF-LOCKING,HE UOC:622	4

END OF FIGURE